

# CONTROL ROOM A



# Battersea Power Station: Control Room A



The 1930s control room is a space for up to 250 guests that celebrates the history of Battersea Power Station. From the restored switchboards and control panels to the Art Deco glass ceiling, this authentic space is an unforgettable setting for events.





# About

## Battersea Power Station: Control Room A



Control Room A is the jewel in the crown of Battersea Power Station, a landmark on the London skyline and an important part of the city's identity.

The room was built to manage the distribution of electricity generated by the Power Station – about a fifth of all the power used by London, including Buckingham Palace. The station was decommissioned in 1975, after which point the building fell into disrepair.

The Grade II listed Art Deco space has been expertly restored by architects WilkinsonEyre, working in close partnership with Historic England.

The original control panels and machinery have been returned to their former glory. The team used a host of new restoration techniques, including digital scanning to exactly replicate the 1930s paint colours and 3D printing to produce missing knobs and buttons of the control desks.

Teak parquet floors, marble finishings and an elaborate gold-coffered glass ceiling bring Art Deco glamour at its most authentic. With a capacity of up to 250 guests, it offers a unique venue for receptions, fashion shows, dinners and launches.





# Battersea Power Station's *immaculately restored* control room.

---

## CAPACITY

250

## SIZE

650 sq m

## ARCHITECTURAL & INTERIOR INFLUENCE

Art Deco  
Iconic  
Industrial

---

## KEY FEATURES

Grade II listed  
Art Deco design  
Heritage features  
Private entrance  
Multiple configurations  
Beautifully restored  
Views into the historic Turbine Hall A

## PERFECT FOR

Art and immersive exhibitions  
Fashion shows  
Product launches  
Brand events  
Dinners & receptions  
Parties

## LOCATION

Turbine Hall A, Battersea Power Station,  
Circus Road West, London, SW11 8AL





# The jewel in the crown of Battersea Power Station

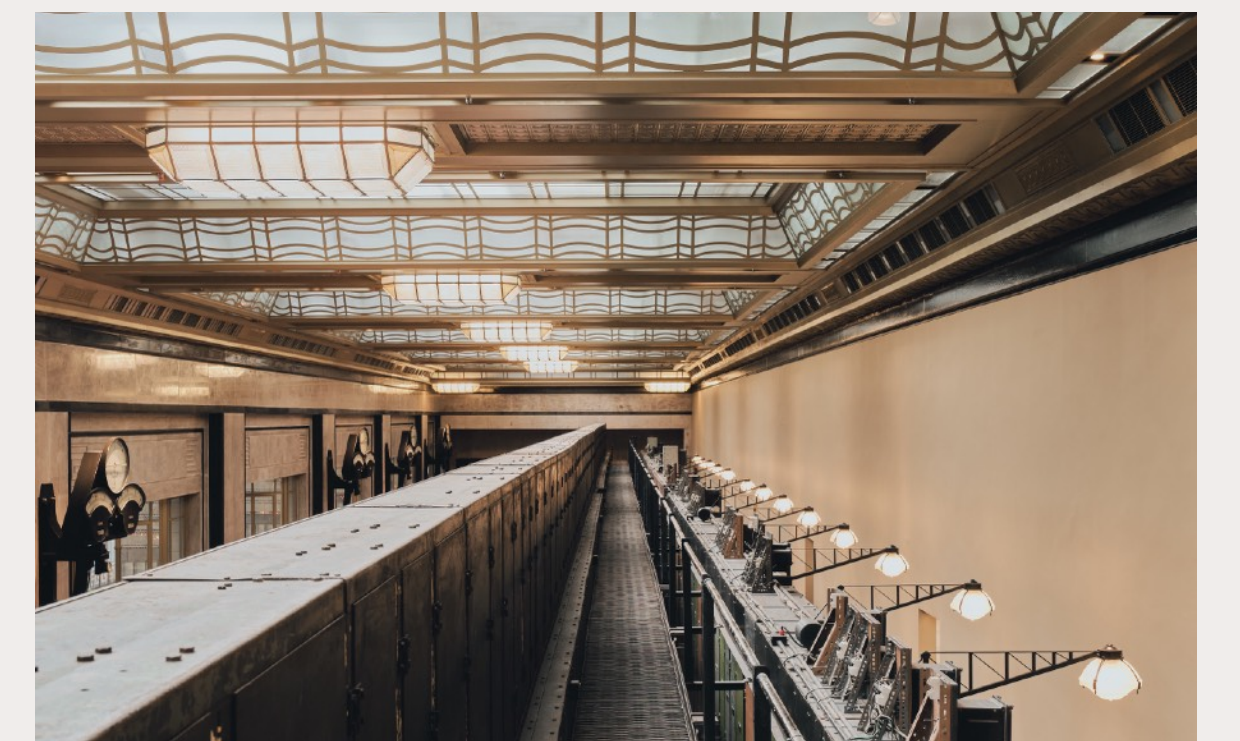



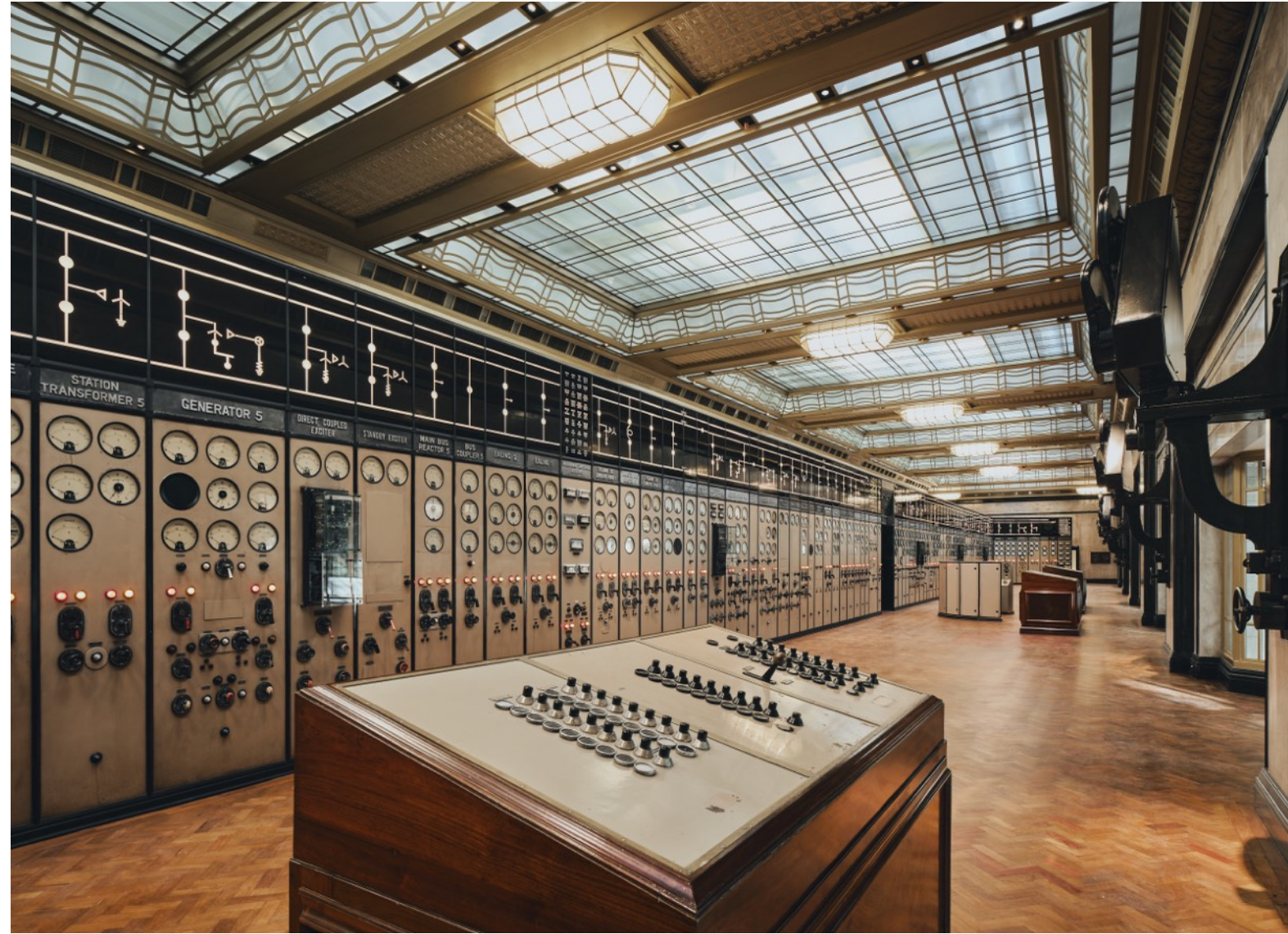





# The restoration of an icon







## *Spaces* The Directors' Entrance

The venue is accessed through the Directors' entrance to the south side of the building. Its impressive bronze doors are decorated with original sculptural panels depicting a personification of energy. The entrance leads to a grand Art Deco lobby, which serves as a perfect place for guest registration.









## *Spaces* Directors' Bar

From the Lobby, guests would travel to the Directors' Bar via the staircase or the original lift, before entering this light filled space featuring a large skylight and window. The Directors' Bar serves as the perfect space for reception drinks, serviced from a brandable, purpose-built bar. The room also has space for a satellite cloakroom and could be used as a catering breakout area between conference sessions, or as an exhibition stand area.









## *Spaces* Control Room A

Control Room A is the main event space, serving 250 guests for a standing reception and up to 100 guests seated for dinner. With beautifully restored control panels in situ, a gold-coffered glass ceiling and original Art Deco finishings, it is a unique and highly memorable space. The perfect setting for celebrations and events including receptions, fashion shows and brand launches calling for a distinctive setting.







# Specifications

All capacities are subject to event floorplans, requirements and final approval.

## Event Spaces

## Dimensions

## Capacity

SPACES	L(M)	W(M)	H(M)	SQ,M	STANDING	THEATRE	DINNER	FASHION
Control Room A	57.87	9.14	3.5 - 6	650	220	135	200	120
Directors' Bar	24.8	9.5	2.55 - 2.68	235	-	-	-	-



# *Floorplan*

## Battersea Power Station: Control Room A

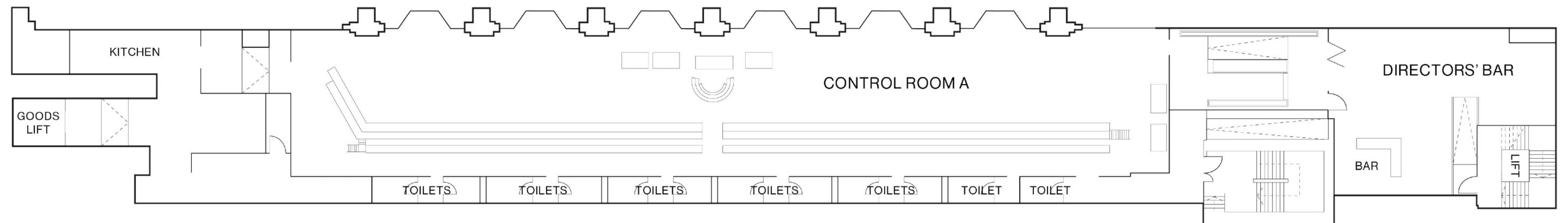



# Preferred Suppliers

Dockyards has mandatory suppliers for venue security, medic provision, cleaning, waste management, traffic management and stewarding. Please speak with your venue contact to request an indicative quotation in response to your event plans.

BRANDING	CONTACT		PHONE	WEBSITE
N2	Michael Woodward	mick.woodward@n2display.com	07720 563 130 / 019 9244 0333	n2display.com
CATERING	CONTACT	EMAIL	PHONE	WEBSITE
KERB	Toby Chaplin	toby@kerbevents.com	07475 348 772	kerbfood.com
Moving Venue	Paigne Norman	pnorman@movingvenue.com	020 8038 8783	movingvenue.com
Dinner Ladies	-	stiritup@dinnerladiesltd.com	020 3793 4126	dinnerladiesltd.com
PRODUCTION, RIGGING AND POWER	CONTACT	EMAIL	PHONE	WEBSITE
Vibration Design and Production	John Wyse	john.wyse@vibration-group.com	70732 604 622	vibrationdp.com
WIFI	CONTACT	EMAIL	PHONE	WEBSITE
Noba	Nick Taylor	nick@noba.co.uk	07810 057 321	noba.co.uk





# Venue Hire

EVENTS	COSTS
Live Event Day	£15,000 per day
Build or Derig Day	£10,000 per day

LOCATION FILMING	COSTS
Shoot Day	£5,000 per day
Prep or Strike Day	£3,000 per day

UNIT BASE	COSTS
Small Unit Base	£3,000 per day
Large Unit base	£5,000 per day

Dockyards London is a dry hire, brown field site and venue hire rates quoted are for land rental only.

The site does not feature existing facilities such as drainage, water, power provision and wet weather proofing. It is recommended that the site be approached as an open air / festival site for any activations. Please see page 8 for further considerations.

Please note that a £10,000 event refundable damage deposit and a £5,000 filming damage deposit is payable and refundable post-hire period upon a pre and post schedule of condition.

All prices quoted are exclusive of VAT.



# Additional costs to consider

## Venue Manager

To be present for every day of occupancy charged at £350 per day (up to 12-hour shift) / £50 per hour for any additional hours. There will be additional charges for bank holidays.

## Security

Supervisors are charged at £25 per hour.  
SIA Guards are charged at £21 per hour.  
Provision will be dependent on the build, layout, capacity and schedule of the event or shoot.

## Event and Traffic Marshals

Supervisor charged at £23.50 per hour. Traffic Marshal charged at £16.50 per hour.  
Event Steward charged at £14.50 per hour.  
If required, marshals may be required to direct guests from the station dependant on capacity. This will be agreed with your venue contact and their provider.

## Catering

Dockyards has a selection of accredited caterers (see page 9). On occasion, we permit external caterers (subject to approval) to work in the space. However, for non-accredited caterers, we ask for a 10% commission on the total F&B spend.

## Wi-Fi

Quote available via Noba.

## Event Medic

Medic charged at £22 per hour.

## Additional Infrastructure

Toilet cabins, cloakroom and event marquees – quote available on request.

## Health and Safety

H&S/EMP review charged at £450 per submission.

## Production, Rigging and Power

Vibration Design and Production are our in-house supplier who can deliver all elements of technical production for you – if you would like to explore a collaboration or buy-out, please advise and we can explore this further with you.

## PRS

Dependent on live and recorded music plans.



# *Location*

---

## ADDRESS

Turbine Hall A,  
Battersea Power Station,  
Circus Road West,  
London, SW11 8AL

## TRANSPORT OPTIONS

Battersea Power Station Underground  
Uber Boat by Thames Clippers  
10 min walk from Battersea Park Station  
23 min walk from Victoria  
28 min walk from Vauxhall  
15 min walk from Queenstown Road Station

## ADDITIONAL DETAILS

Local cultural highlights include the Saatchi Gallery and Battersea Park. Benefits from a dedicated London Underground station on the recently extended Northern Line.







## *Neighbourhood*

Battersea Power Station is one of London's most recognisable buildings. Built between 1929 and 1935, it sits on the south bank of the River Thames as a legacy to the city's industrial past.

The Power Station lay in disrepair after it was decommissioned in the 1970s. The current redevelopment project involved conservation and restoration of the building's Art Deco. The revival of the site has drawn Apple Inc to make it the home of their London Campus.

The Power Station is the heart of the 42-acre development, which provides an innovative place to shop, eat, drink, live, work and play with over 100 shops, restaurants, leisure attractions (including Lift 109) and hundreds of homes for the city's workers. The Grade II listed building encompasses London's most exciting shopping and leisure destination south of the river.



Untold *possibilities*

# Spaces & Stories





Spaces & Stories is an eclectic collection of *out-of-the-ordinary* venues and locations.

We are an established Venue Operator with a difference. Our sites range in style and scale, but are all individual in character, from landmark locations to cultural cornerstones. We help you create stories that endure.





Untold *possibilities*

THANK YOU

+44 (0)203-319-9332  
[www.spacesstories.com](http://www.spacesstories.com)

Spaces & Stories